



TALLGRASS PONY EXPRESS PIPELINE, LLC

Tallgrass Carpenter Lateral Project

Tallgrass Pony Express Pipeline, LLC ("Tallgrass") is proposing to construct and operate an approximately 16-mile, 12" steel, crude oil pipeline in unincorporated Laramie County, WY, known as the Carpenter Lateral (the "Pipeline").

The overall Carpenter Lateral is comprised of 25 miles in Weld County, CO and Laramie County, WY and is an extension of the existing Pony Express Pipeline, which stretches about 830 miles from Guernsey, WY to Cushing, OK.

The Pipeline is proposed to originate near the center of Section 21, Township 14 North, Range 64 West, 6th P.M. (approximately 1.5 miles west of the TA Travel Center and the County Road 140 exit), then route easterly 3.5 miles across County Road 142, then turn south crossing under I-80 and continuing in a southerly direction, exiting Laramie County in Section 16, Township 12 North, Range 63 West, 6th P.M. (a map of the route is included in this letter).

Tallgrass is building the Pipeline to transport crude oil being produced in Laramie County and surrounding areas on to refineries in Kansas and Oklahoma and/or the Cushing, OK storage hub.

Currently, the construction of the pipeline is planned to commence in early 2020, with completion of construction and an in-service date expected in the Summer of 2020.

About Tallgrass:

Tallgrass Energy is a midstream energy infrastructure company operating more than 9,300 miles of pipelines across 11 states, with transportation, storage, terminal, water, gathering and processing assets. Our operations headquarters is in Lakewood, CO, and we have more than 130 employees in Wyoming.

We are committed to being a good neighbor, and that begins by being open and transparent. We strive to keep the public informed and provide opportunities for stakeholders to give input and share their views.

At Tallgrass Energy, safety comes first. At the end of the day, the most important measure of our success is the safety of our people, our communities, and our environment.

If you have any questions, please don't hesitate to contact me at 303-763-3305 or cody.wagoner@tallgrassenergyllp.com.

Sincerely,

Tallgrass Pony Express Pipeline, LLC

A handwritten signature in blue ink, appearing to read "Cody Wagoner", is written over the printed name.

Cody Wagoner
Senior Agent, Land & Right of Way

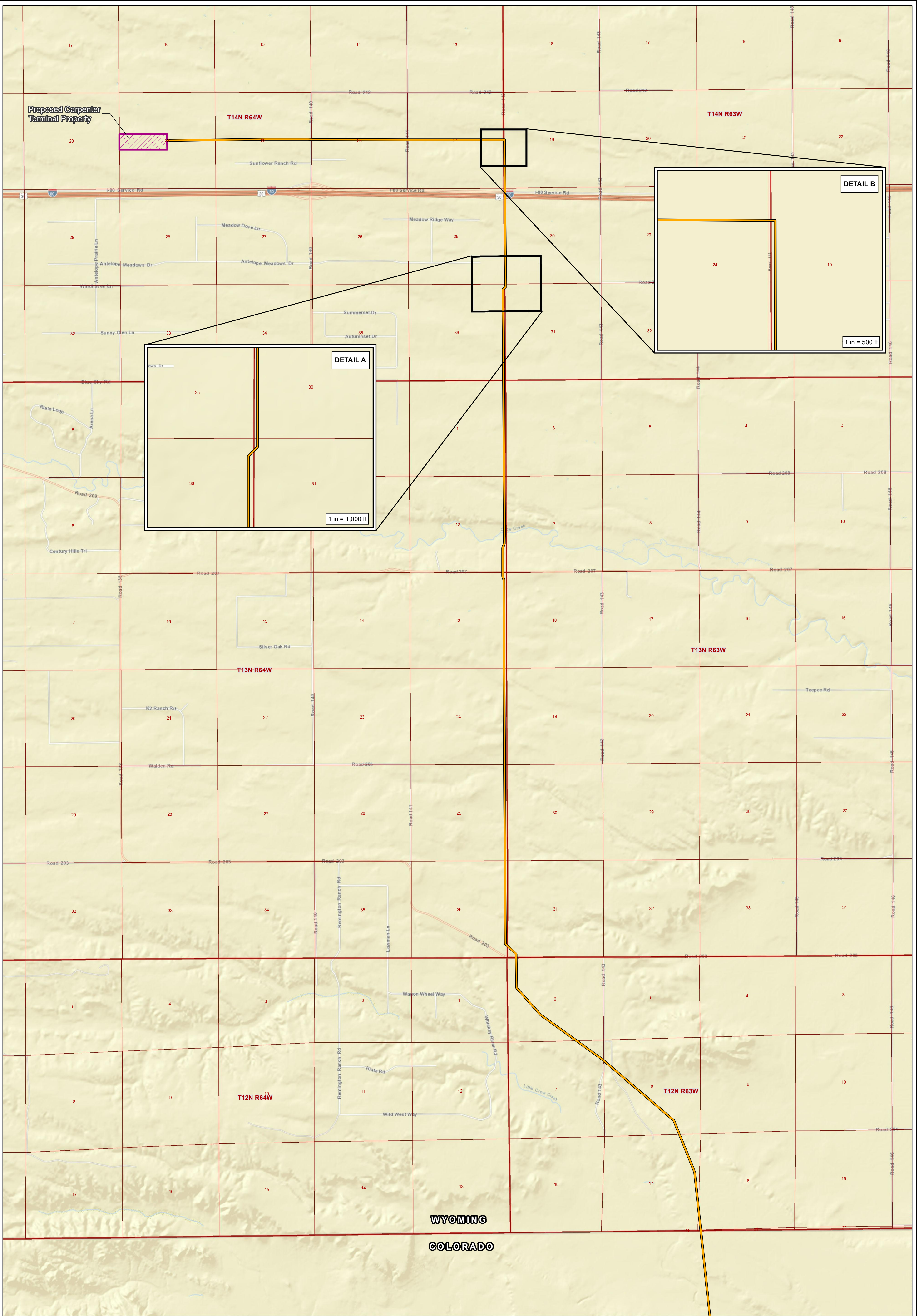

Legend		General Information		Preliminary Construction Overview					
<div><div></div>Proposed Pipeline</div> <div><div></div>Section Boundary</div> <div><div></div>Township Boundary</div>		<p>ALL BEARINGS, DISTANCES, AND COORDINATES CONTAINED HEREON ARE GRID BASED UPON THE STATE PLANE COORDINATE SYSTEM, WYOMING EAST, N.A.D. 1983, U.S. SURVEY FEET.</p> <p>WARNING</p> <p>NO ATTEMPT HAS BEEN MADE TO LOCATE UNDERGROUND OBSTRUCTIONS OR UTILITIES SHOWN HEREON. THEY ARE APPROXIMATE AND DERIVED FROM PUBLIC RECORD SOURCES. THERE MAY BE OTHER UTILITIES/OBSTRUCTIONS BOTH ABOVE AND BELOW GROUND OTHER THAN WHAT IS SHOWN HEREON. NO GUARANTEE IS MADE OR IMPLIED AS TO OWNERSHIP OF UTILITIES, ROADS, MUNICIPAL/POLITICAL BOUNDARIES. IT IS STILL THE CONTRACTOR'S RESPONSIBILITY TO LOCATE ALL ABOVE/BELOW GROUND INFRASTRUCTURE WITHIN THE PROJECT AREA. CONTRACTOR MUST CONTACT A PUBLIC UTILITY LOCATION SERVICE FOR BOTH WY AND THE OWNERS OF IMPACTED INFRASTRUCTURE TO VERIFY THEIR LOCATION. THIS DOCUMENT IS NOT FOR CONSTRUCTION PURPOSES NOR IS IT INTENDED TO BE FILED OF RECORD FOR EASEMENT OR ANY OTHER PURPOSE.</p>		<div><div><div>TALLGRASS</div><div>ENERGY</div></div><div><div><div></div><div>TOPOGRAPHIC</div><div>LOYALTY INNOVATION LEGACY</div></div><div>520 Stacy Court Ste B, Lafayette, CO 80026 303.666.0379 www.topographic.com</div></div></div>		<div><div><div><div>N</div><div>E</div><div>S</div><div>W</div></div></div><div><h1>Carpenter Lateral</h1><h1>Proposed Pipeline</h1><h1>Laramie County, WY</h1></div></div> <div><div>Scale:</div><div><div>01,2502,5003,750</div><div><div></div></div><div>1 inch = 2,500 feet</div></div><div><div>Original Size:</div><div>24" x 36"</div></div><div><div>Date:</div><div>12/11/2019</div></div><div><div>By:</div><div>DJE</div></div></div>			

RESOLUTION # _____

**ENTITLED: A RESOLUTION FOR A PUBLIC HEARING FOR THE TALLGRASS
CARPENTER ENERGY PIPELINE.**

WHEREAS, Wyoming State Statutes §18-5-201 to 18-5-208; §18-5-301 to 18-5-315 authorize Laramie County, in promoting the public health, safety, morals and general welfare of the county, to regulate the use of land through zoning in unincorporated Laramie County; and

WHEREAS, The Laramie County Board of Commissioners have previously adopted the Laramie County Land Use Regulations; and

WHEREAS, this application conforms with Section 2-2-127 of the Laramie County Land Use Regulations governing approval criteria for energy pipelines; and

NOW THEREFORE BE IT RESOLVED BY THE GOVERNING BODY OF LARAMIE COUNTY, WYOMING, as follows:

The Laramie County Board of Commissioners finds that this application satisfies Section 2-2-127 of the Laramie County Land Use Regulations in that both a public hearing has occurred and a route map has been or is being reviewed by the Laramie County Planning Department.

PRESENTED AND ADOPTED this _____ day of _____, 2020.

LARAMIE COUNTY BOARD OF COMMISSIONERS

Amber Ash, Chairman

ATTEST:

Debra K. Lee, Laramie County Clerk

Reviewed and approved as to form:

Laramie County Attorney's Office